

DO NOT SCALE
IF IN DOUBT ASK

REF NO 3491

Window Details

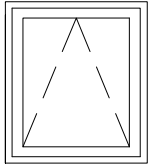

940mm x 1090mm
UPVC
Double Glazed
Tricklet Vents
Restrictor Stays
Lockable Handles

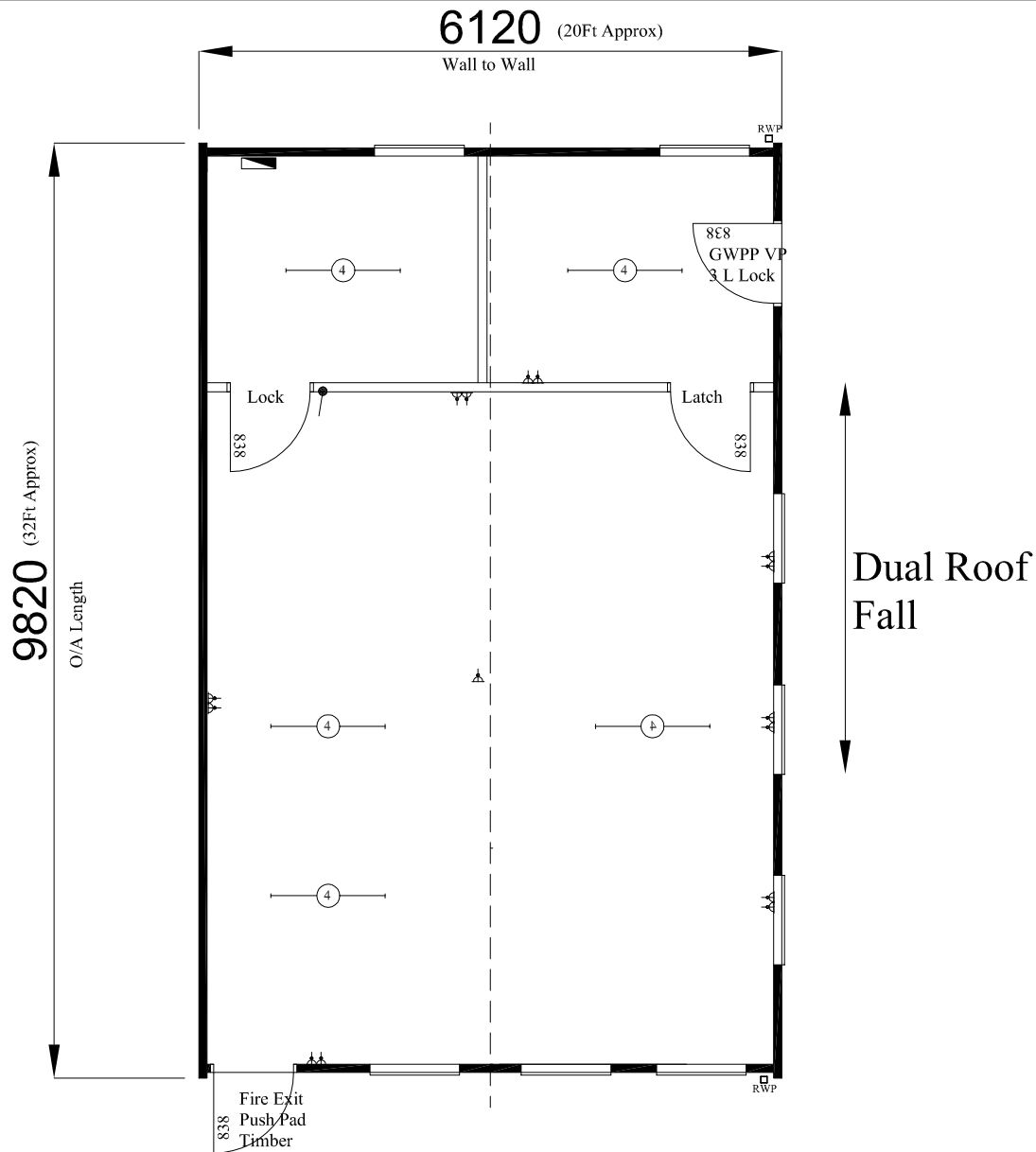

Yard Location: Area F
Roof Type: Marley
FFL - 425mm
Ceiling Height - 2430mm
O/A Height Of Building: 3500mm

©copyright
Foremans
Relocatable Building Systems
Catfoss Lane, Brandesburton,
Drifffield, East Yorkshire, YO25 8EJ
Telephone : 01964 544344 Fax : 01964 542141
E-mail : sales@foremansbuildings.co.uk
Web : http://www.foremansbuildings.co.uk

CLIENT	SQM AREA = 61 SQM	SCALE	1:75
	SQFT AREA = 652 SQFT	DRAWN BY	C.W Rowson
TITLE	REVISION	DATE	15.08.08
		DWG NO	ST/3491-1
		REV	
		Original Size A4	

**2 Bays of Redispace Modular
Building 32Ft x 10Ft Bays**